

GRRIP I Watershed Analysis for Fall River, MA

Estimates of Land Use, Impervious Surface and Annual Nonpoint Source Pollution Loads

Watershed 2

Land Use Allocation 237.5 acres

- Forest (62.1%)
- Open Land (21.0%)
- Water (11.0%)
- Wetland (1.0%)
- Other (3.9%)



Land Use Area in Acres is 237.5

Impervious Area is 2.7 Acres

Percentage of Imperviousness = 1.1%

Avg Annual Nitrogen Load = 634.3 pounds

Avg Annual Phosphorus Load = 35.2 pounds

Avg Annual Suspended Solids = 7304.1 pounds



Inset of Watershed Location

Land Use Types

- Crop Land
- Pasture
- Forest
- Non-Forest Wetland
- Mining
- Open Land
- Participation Rec.
- Spacious Rec.
- Water-based Rec.
- Multi-Fam. Res.
- High Density Res.
- Medium Dens. Res.
- Low Dens. Res.
- Salt Water Wetland
- Commercial
- Industrial
- Urban Open
- Transportation
- Waste Disposal
- Water
- Woody Perennial

The GRRIP I (Geographic Roadway Runoff Inventory Program) is an analysis of roadway drainage facilities located in an incrementally wide area on defined Federal Aid Eligible Roads. GRRIP I analyzed towns in the SRPEDD region that fall within the Buzzards Bay Watershed. The Watershed Analysis Project further details several of the drainage systems within each of the towns in the Buzzards Bay Watershed to show the general health of the contributing watershed from the specified drainage system by extrapolating its area of imperviousness using the Schuler Watershed Methodology and the Watershed Tools Extension developed by Mass GIS.

The drainage posts located at the Brookside Park in Fall River, MA, are a good example of a drainage system that is not properly maintained and is in need of repair.



POINT, DRAIN 1, BROOKSIDE PARK, FALL RIVER, MA. PHOTO BY: [Name]



POINT, DRAIN 2, BROOKSIDE PARK, FALL RIVER, MA. PHOTO BY: [Name]

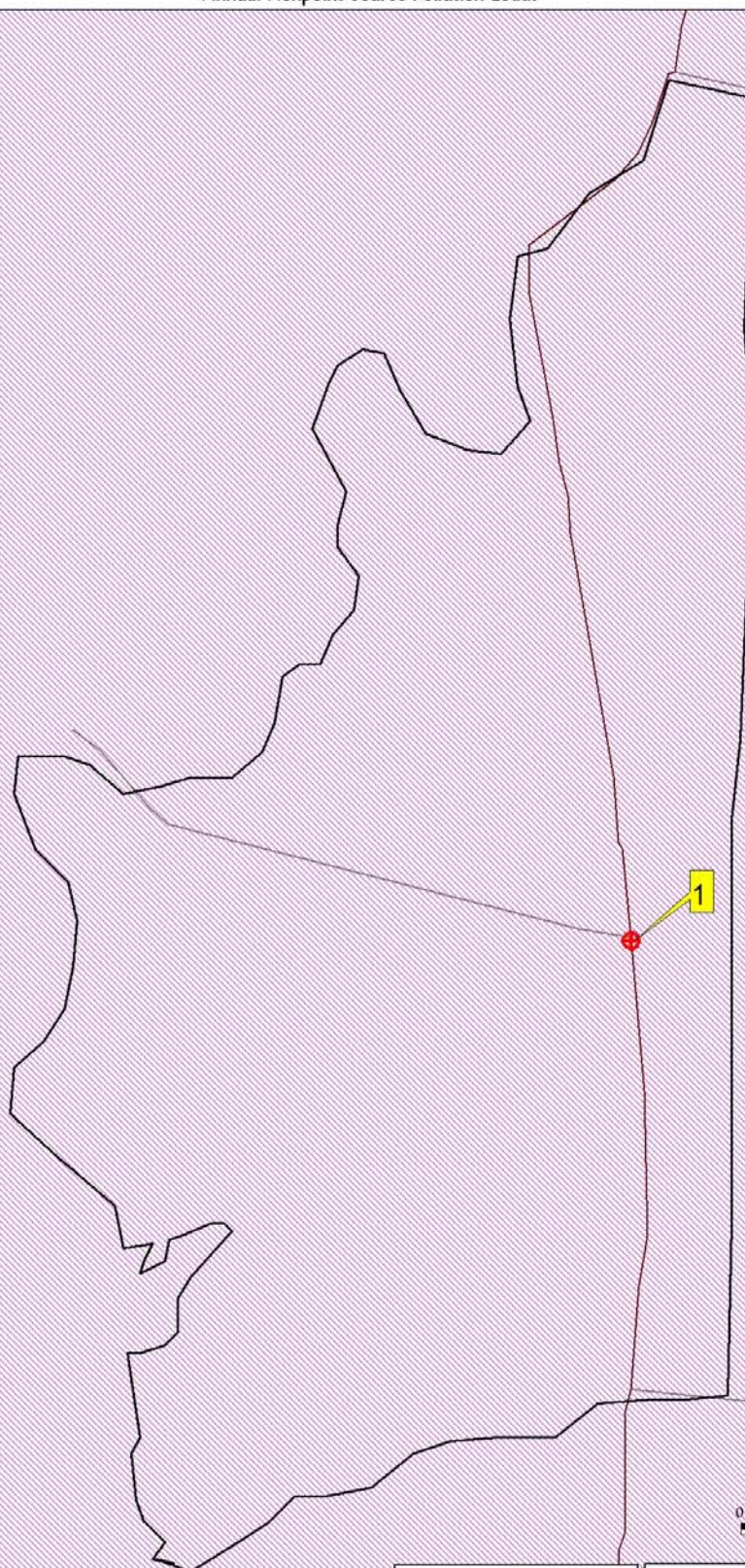

- Drainage System
- Potential Vernal Pools
- Certified Vernal Pool
- Public Water Supply
- Public Beach
- Shellfish Beds
- Rarebird_noon.shp
- Rarefish_noon.shp
- Rarecrustacean.shp
- Rareinvertebrate.shp
- Rareinvertebrate_noon.shp
- Intermittent Wetland Protect
- Cold Water Fisheries
- Anadromous Fish Run
- Critical Area after Storm Event
- Wetlands
- Solid Waste Facility
- Estimated and Priority Habitats
- ACEC
- Zone 2
- Zone B
- Rivers and Streams
- Lakes & Ponds
- Road Island Towns
- Other MA Towns
- Town Boundary
- Ocean
- Transmission Lines
- Railroad
- Roads
 - Local Rd & Non-Eligible Functional Class Rds (F-0/F-6)
 - Principal (F-1)
 - Rural Principal Arterial & Urban Bd (F-2)
 - Rural Minor Arterial & Urban Bd (F-3)
 - Other Urban Principal Arterial (F-4)
 - Urban Minor Arterial or Rural Major Collector
 - Urban Collector or Rural Minor Collector (F-5)

Watershed Analysis produced using the Watershed Tools Extension developed by Mass GIS.

Map prepared by: [Name]
SRPEDD
1001 E. MA 1A
August 2003



The following data sources from the Massachusetts Heritage & Environmental Survey are used in this map. In addition, the map was developed using the following:

Geographic Information System (GIS) Data:

- MA DEP 1999-2001: Estimated Number of Rare Wetlands. Use with the Watershed Extension.
- MA DEP 1999-2001: Priority Wetlands of State Listed Areas. Use with the Watershed Extension.
- MA DEP 1999-2001: Priority Wetlands of State Listed Areas. Use with the Watershed Extension.
- MA DEP 1999-2001: Priority Wetlands of State Listed Areas. Use with the Watershed Extension.

Certified Vernal Pools:

- MA DEP 1999-2001: Massachusetts Certified List of Pools

This response was produced by SRPEDD (Southwest Region of Planning and Economic Development Districts, Inc.). Portions of the aerial digital data used in this map were provided by the Massachusetts Executive Office of Environmental Affairs (MassDEA), Capital Corporation of Boston, MA. SRPEDD is the former of Transportation Planning & Development, Division of the Federal Highway Administration (FHWA), Division of the State, U.S. Fish & Wildlife Service, Coastal Zone Management National Oceanic & Atmospheric Administration (NOAA).

The location of natural resources shown on this map are approximate and are intended for planning purposes only. This map is not intended for legal.

The funding for this project was provided by the Executive Office of Transportation (DOT) and the Massachusetts Highway Department.

